

THIS DOCUMENT IS THE PROPERTY OF STUDIO 3 DESIGN GROUP, P.C. THE UNAUTHORIZED REPRODUCTION, COPYING OR OTHERWISE USE OF THIS DOCUMENT IS STRICTLY PROHIBITED AND ANY INFRINGEMENT THEREUPON MAY BE SUBJECT TO LEGAL ACTION.  
COPYRIGHT 2006 STUDIO 3 DESIGN GROUP, P.C.

IN ASSOCIATION WITH  
**CRAIG GAULDEN** architecture  
**DAVIS** interiors

MEMBERS OF THE AMERICAN INSTITUTE OF ARCHITECTS  
W.R. Toole Engineers, Inc.  
348 Commerce Street, Augusta, GA 30901  
CIVIL ENGINEERING  
Mike M. Simpson & Associates, Inc.  
215 East Broad Street, Augusta, GA 30901  
STRUCTURAL ENGINEERING  
Prueff, Ford and Associates, Inc.  
1201 Broad St., Suite 3A, Augusta, GA 30901  
MECHANICAL AND PLUMBING ENGINEERING  
Electrical Design Consultants  
1201 Broad St., Augusta, GA 30901  
ELECTRICAL ENGINEERING

ROOF PLAN REVISED  
NEW PLAN FOR THE  
**EAST CENTRAL GEORGIA REGIONAL LIBRARY**  
TELF AIR & NINTH STREET  
AUGUSTA, GA

PROJECT NUMBER 200607  
DRAWN BY: S320  
CHECKED BY: S320  
ISSUE DATE: 05/02/08  
PLOT DATE: 4/2/2010  
REVISIONS  
ADD WALL PADS SHOWN  
A5.1R

ROOF PLAN LEGEND	
	ROOF DRAIN - SEE PLUMBING DRAWINGS AND DETAIL 11/A5.2
	EMERGENCY OVERFLOW DRAIN - SEE PLUMBING DRAWINGS AND DETAIL 5/A5.2
	OVERFLOW SCUPPER - SEE EXTERIOR ELEVATIONS AND DETAIL 7/A5.2
	INDICATES SLOPE OF ROOF AND DIRECTION OF SLOPE
	COLUMN LINES - SEE AREA FLOOR PLANS

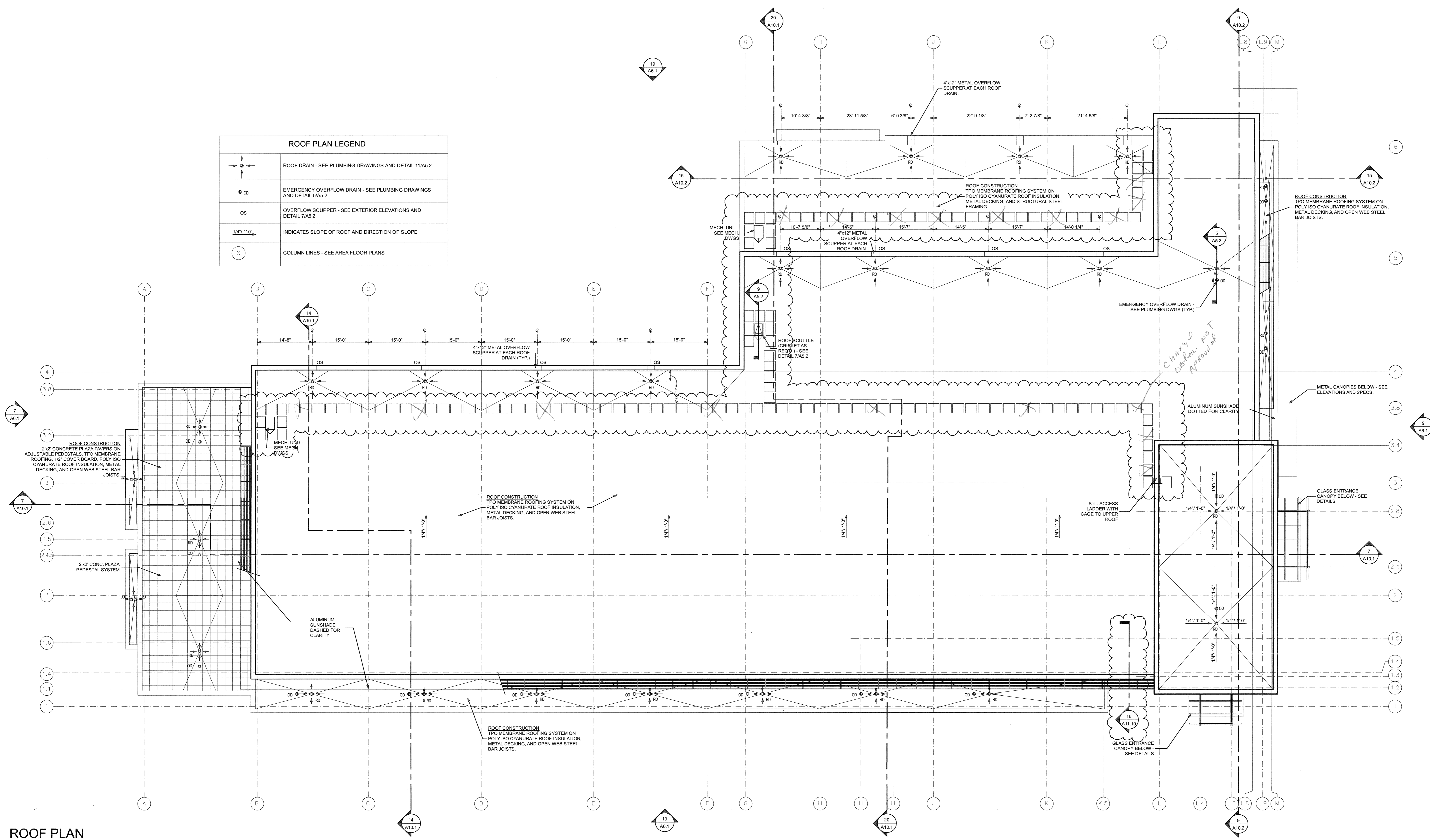

**19**  
**A5.1R**  
ROOF PLAN  
SCALE: 3/32" = 1'-0"